

200100

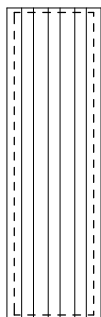

200200

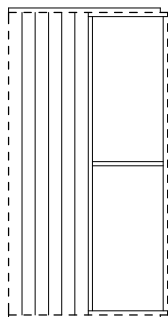

200110

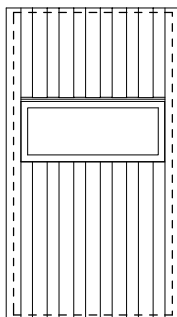
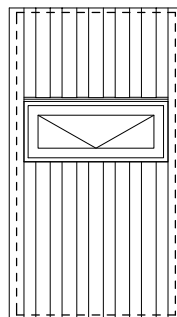
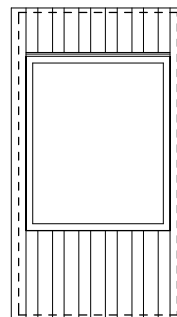
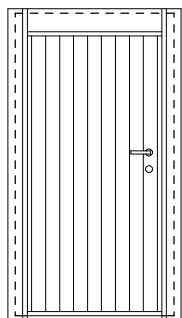
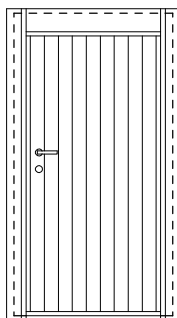
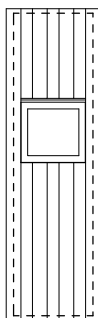
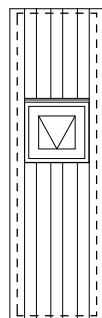
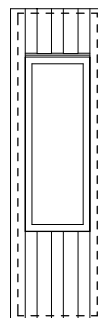
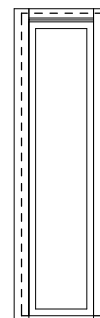
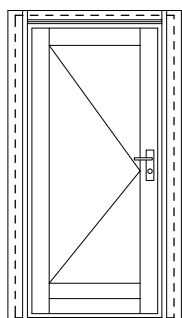
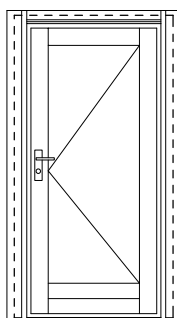
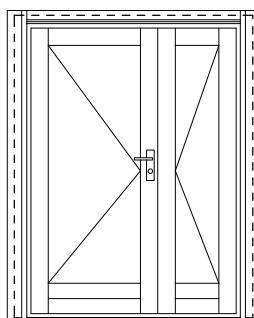
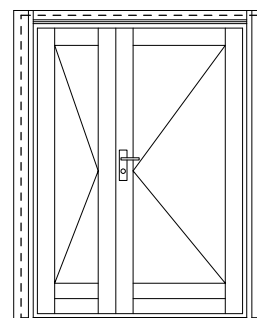
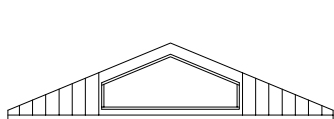
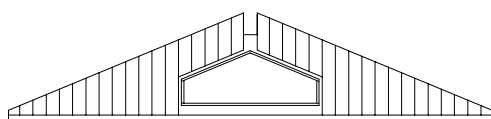
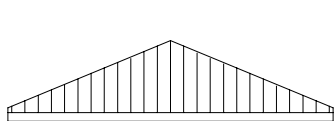
200131
VT200132
VTO200141
VT200120
DV200121
DH200211
VT200212
VTO200221
VT200230
VT200122
DTV200123
DTH200320
DTV2200321
DTH2500152
GT500162
GT

500150

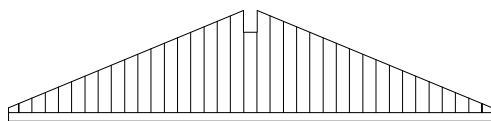

500160

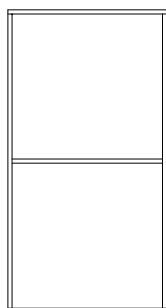
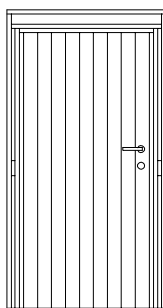
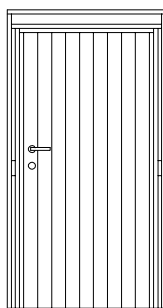
SKILLEVÆGSELEMENTER:200115
S200126
DSV200127
DSH

Alle elementer er set udefra.

Døre er udadgående.

Vinduer er tophængte udadgående.

VT = Vindue Termo.

VTO = Vindue Termo Oplukkelig.

DV = Dør Venstrehængt.

DH = Dør Højrehængt.

DTV = Dør Termo Venstrehængt.

DTH = Dør Termo Højrehængt.

DTV2 = Dør Termo Venstrehængt 2 fløjet.

DTH2 = Dør Termo Højrehængt 2 fløjet.

GT = Gavl Termo.

S = Skillevæg.

DSV = Dør Skillevæg Venstre.

DSH = Dør Skillevæg Højre.

Kongeriget Danmark
Designbeskyttet havelås

SAG: Flexanex

EMNE: Elementoversigt

DATO: 01.03.2021

SIGN.: sbm

REV. DATO:

TEGN.NR.(99)1.3

MÅL: 1:50